

# STRATA KITCHENS

## TOOLS NEEDED/

POWER DRILL

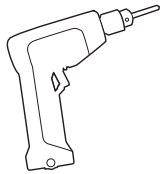

3MM DRILL BIT

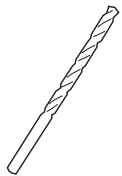

PHILLIPS HEAD SCREW DRIVER

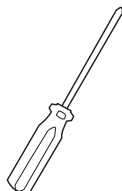

## THIS PACK INCLUDES/

### WALL CORNER CABINET TYPE/

600MM WALL

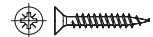

50MM CABINET FIX SCREW  
28MM HEAD HOLE SCREW  
60MM HEAD HOLE SCREW

22  
04  
04



WHITE COVER CAP

08



ADJUSTABLE SHELF SUPPORT

04



DOWEL PIECES

04

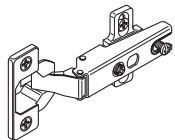

170° HINGE & PLATE

02

PIE CUT HINGE & PLATE

02

DOOR BUFFER

01



# x SHELF  
# x BOTTOM  
# x BACK  
# x END  
# x TOP

01  
01  
02  
02  
01

# WALL CORNER CABINET/INSTRUCTIONS

## HOW TO ASSEMBLE/ STEPS 01-04 OF 04

### STEP ONE/01

Place the base panel on edge. Join the two end panels and top panel using locating dowels and 50mm screws.

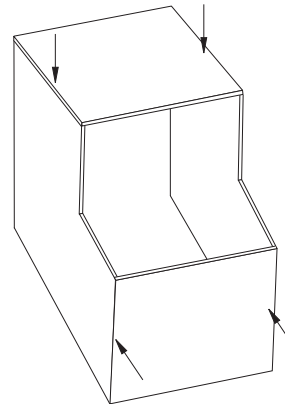

### STEP TWO/02

Turn cupboard over and fix back panels into place using 50mm fixing screws.

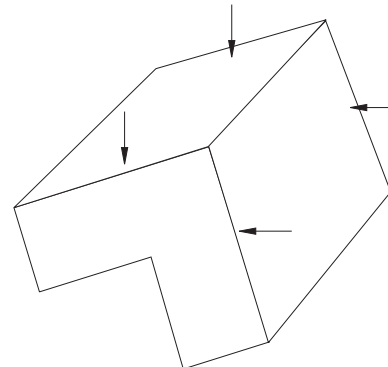

### STEP THREE/03

Place cabinet against wall corner at desired height and ensure that cabinet is level. Screw fix to wall studs with 60mm headhole screws and finish with cover caps. Fix additional wall cabinets to the adjoining end panel (after securing to wall studs) with the 28mm headhole screws. Finish with white cover cap.

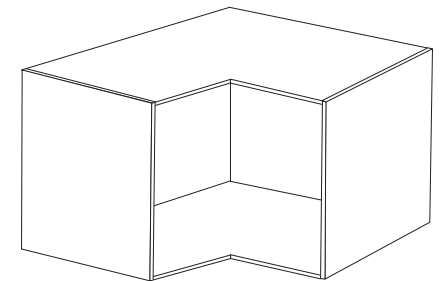

### STEP FOUR/04

Fit adjustable shelf supports in holes at both end at your chose height. Fit shelf.

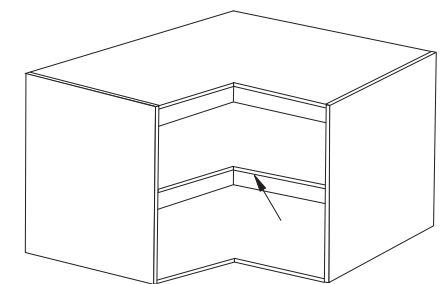

# STRATA KITCHENS

## HOW TO MOUNT DOORS/ STEPS 01-06 OF 06

[STRATAKITCHENS.COM.AU/](http://STRATAKITCHENS.COM.AU/)  
INSTRUCTIONS

### STEP ONE/01

The corner door application is made up of 2 doors. Door A is identified by 4 x Ø 35mm holes for the hinges, and door B by 4 x Ø 5mm holes for the mounting plates.

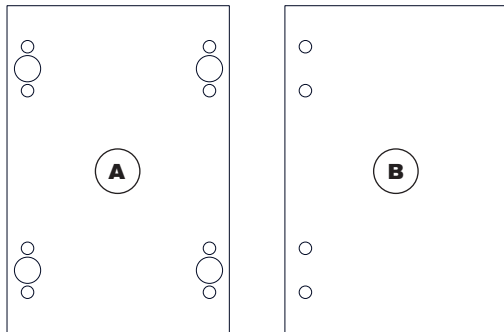

### STEP TWO/02

Identify 2 x 170° hinges and 2 x pie cut corner hinges from the hardware pack and attach hinges to inside of door panel. Position body of hinge in 35mm diameter hole and screw in place using hinge screws either side of hinge cup. Note placement of hinge types 1 and 2:

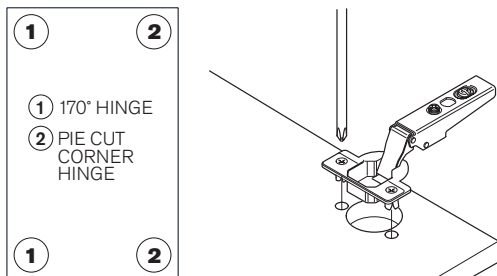

### STEP THREE/03

Attach mounting plates to door panel B at corresponding mounting plate holes. Also attach mounting plate to inside cupboard panel, ensuring that the mounting plate aligns with hinge placement on the door.

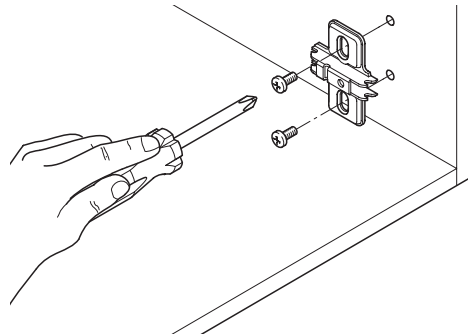

### STEP FOUR/04

Attach door A to mounting plate using the 170° hinge, by pressing the hinge arm onto the mounting plate and ensure that the arm 'clicks' into place.

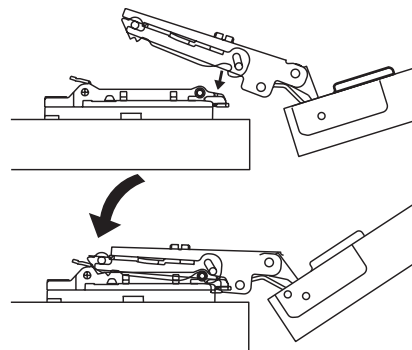

### STEP FIVE/05

Attach door B to corresponding pie cut corner hinge arms and ensure that the arms 'click' into place.

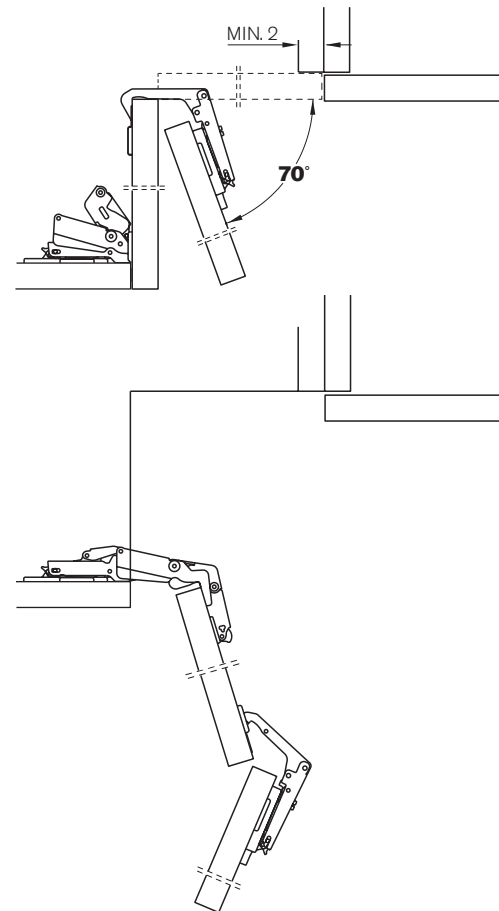

### STEP SIX/06

Adjust doors via the hinge arm and plate to obtain correct gaps.